

FUNCTION ROOMS

(2/F)

Chi Wo Street

31m

High Ceiling=2.52m

Dropped Ceiling=2.3m

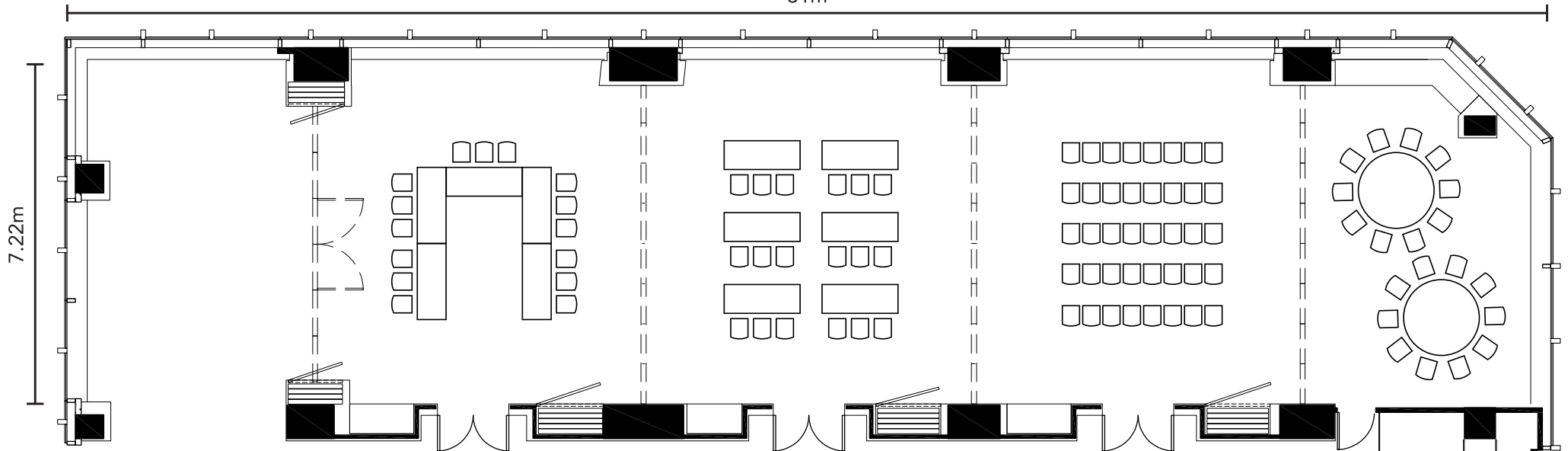

FOYER

W=4.8m
L=7.22m
Area=30m²

FUNCTION ROOM 4

W=7.43m
L=7.22m
Area=52m²

FUNCTION ROOM 3

W=6.84m
L=7.22m
Area=49m²

FUNCTION ROOM 2

W=6.87m
L=7.22m
Area=49m²

FUNCTION ROOM 1

W=4.8m
L=6.67m
Area=32m²