

# FUNCTION ROOMS

(2/F)

Chi Wo Street

31m

Ceiling Height=2.52m  
Foyer Ceiling Height=2.4m

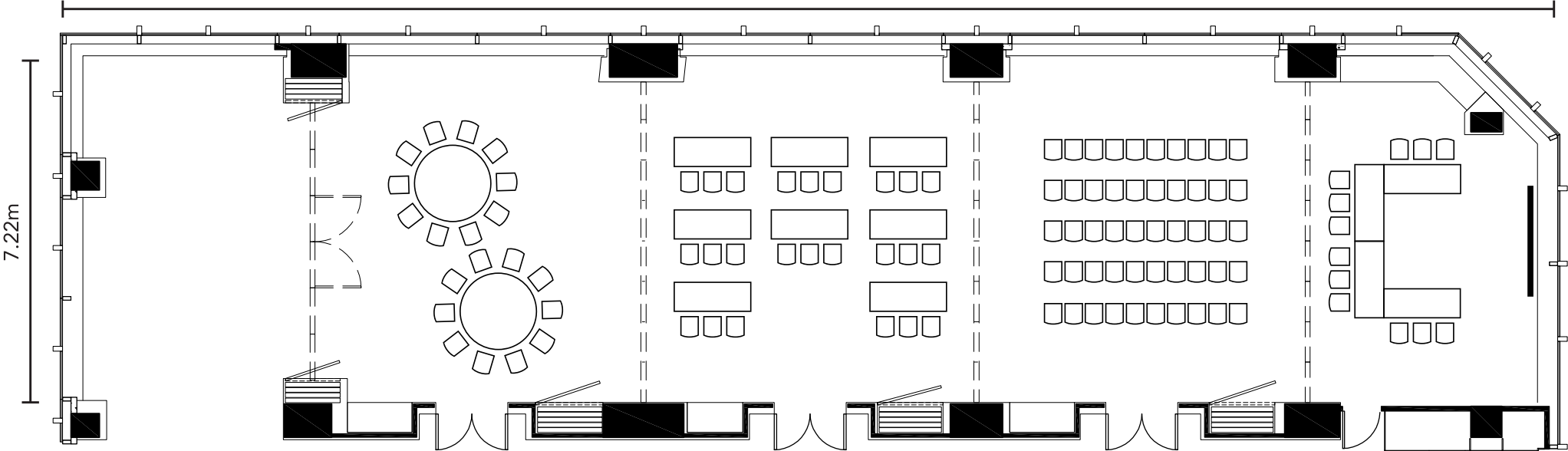

**FOYER**

W=4.2m  
L=7.22m  
Area=30m<sup>2</sup>

**FUNCTION ROOM 4**

W=7.43m  
L=7.22m  
Area=54m<sup>2</sup>

**FUNCTION ROOM 3**

W=6.84m  
L=7.22m  
Area=49m<sup>2</sup>

**FUNCTION ROOM 2**

W=6.87m  
L=7.22m  
Area=50m<sup>2</sup>

**FUNCTION ROOM 1**

W=4.8m  
L=7.22m  
Area=33m<sup>2</sup>